

No. 26-\_\_\_\_\_

---

---

In the  
**Supreme Court of the United States**

---

HAZEN HUNTER WINCKLER,  
*Petitioner,*

v.

STATE OF SOUTH DAKOTA,  
*Respondent.*

---

**On Petition for Writ of Certiorari to the  
Supreme Court of South Dakota**

---

**PETITIONER'S APPENDIX  
VOLUME 7  
APP. C-2 & App. D-1 – App. D-2**

---

Tucker J. Volesky  
*Counsel of Record*  
305 N. Kimball  
Mitchell, SD 57301  
(605) 996-5542  
tucker.volesky@  
tuckervoleskylaw.com  
*Counsel for Petitioner*

---

---

## INDEX TO APPENDICES

### Appendix A:

- App. A-1 – South Dakota Supreme Court Judgment and Opinion in *State v. Winckler*, 2026 S.D. 19
- App. A-2 – South Dakota Circuit Court Memorandum Decision (Jurisdiction), *State v. Winckler*
- App. A-3 – Transcript of Motions Hearing on Motions to Dismiss regarding Jurisdiction, *State v. Winckler*, held before the State Circuit Court on September 11, 2024 (including parties’ stipulations)
- App. A-4 – South Dakota Supreme Court Opinion in *Bruguier v. Class*, 1999 S.D. 122, 599 N.W.2d 364

### Appendix B:

- App. B-1 – Treaty of Apr. 19, 1858, 11 Stat. 743
- App. B-2 – Act of Aug. 15, 1894, ch. 290, 28 Stat. 286, 314-319
- App. B-3 – 25 C.F.R. § 12.21
- App. B-4 – 25 U.S.C. §§ 2 & 13
- App. B-5 – 34 U.S.C. §§ 20903 & 20911
- App. B-6 – 20 U.S.C. §§ 7701 et seq
- App. B-7 – 34 C.F.R. § 222, Subpart G
- App. B-8 – 25 U.S.C. §§ 1901 et seq
- App. B-9 – 25 C.F.R. § 23.101
- App. B-10 – YST, Title II, Rule 33
- App. B-11 – 25 U.S.C. § 177
- App. B-12 – 25 Stat. 676

### Appendix C:

- App. C-1 – Affidavit of Tucker J. Volesky, filed in *State v. Winckler* with exhibits:
  - Exhibit 3, United States Trust Patent dated May 8, 1891, filed with the Register of Deeds in Charles Mix County on December 2, 1903
  - Exhibit 12, U.S. Department of Commerce, 2020 U.S. Census Tribal Tract Map: Yankton Reservation
  - Exhibit 13, U.S. Department of Interior, Indian Affairs webpage, Yankton Agency
  - Exhibit 16, Letter from Yankton Sioux Tribe Chairman to United States Department of Interior, enclosing Protocols for Consultation with the Yankton Sioux Tribe
  - Exhibit 17, Argus Leader article titled, “*State says no to Yankton Sioux Tribe’s ask for National Guard help with flooding;*” published Sept. 24, 2019
  - Exhibit 21, Application and Grant Agreement between U.S. Department of Transportation and the Yankton Sioux Tribe, March 2021
  - Exhibit 22, Yankton Sioux Tribe Comprehensive Economic Development Strategy, September 2022
  - Exhibit 23, South Dakota Searchlight article titled, “*Homicide investigation sparks rare level of state-tribal cooperation;*” published May 31, 2024
- App. C-2 – Affidavit of Chelsea Wenzel, filed in *State v. Winckler* with exhibits:
  - State’s Exhibit F, Andes Central School District#11-1, Indian Policies and Procedures (IPP) Impact Aid Program

### Appendix D:

- App. D-1 – 2020 Census Tribal Tract Map: Yankton Reservation
- App. D-2 – 2020 Census Tribal Block Groups, Form G-600

STATE OF SOUTH DAKOTA	)	IN CIRCUIT COURT
: SS	)	
COUNTY OF CHARLES MIX	)	FIRST JUDICIAL CIRCUIT
STATE OF SOUTH DAKOTA,	)	
	)	11 CRI 23-172
Plaintiff,	)	11 CRI 23-297
	)	
v.	)	
	)	AFFIDAVIT
HAZEN HUNTER WINCKLER,	)	
	)	
Defendant.	)	
STATE OF SOUTH DAKOTA	)	
	)SS	
COUNTY OF HUGHES	)	

Chelsea Wenzel, being first duly sworn, upon her oath testifies and states as follows:

1. That I am an attorney with the Attorney General's Office in Pierre, South Dakota.
2. That I am counsel for the Plaintiff, State of South Dakota, in the above-captioned action.
3. That I make this Affidavit to make certain documents part of the record which are relevant to the Defendant's Motion to Dismiss.
4. That attached to this Affidavit are true and correct copies of the following:
  - Exhibit A – Copies of the Defendant's brief, State's brief, and Court's decision in *State v. Selwyn*, Charles Mix County Criminal No. 20-276.
  - Exhibit B – The chain of title for 126 North Second Avenue in Lake Andes, obtained from the Charles Mix County Register of Deeds.

Exhibit C – GIS Map, created by the Charles Mix County GIS Administrator, showing the parcels of land owned by the Yankton Sioux Tribe within the city limits of Lake Andes, South Dakota.

Exhibit D – Chapter 19 of the Lake Andes City Code, obtained from the City of Lake Andes Finance Officer.

Exhibit E – Agreement for Law Enforcement Services between the City of Lake Andes and Charles Mix County, obtained from the Charles Mix County Sheriff's Office.

Exhibit F – Andes Central School District #11-1 Indian Policies and Procedures (IPP) Impact Aid Program, obtained from the Andes Central School website.

Exhibit G – Charles Mix County GIS Fire District Map, obtained from the County GIS website.

FURTHER YOUR AFFIANT SAYETH NAUGHT.

Dated this 6th day of September 2024.

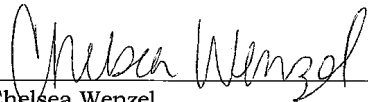
  
Chelsea Wenzel  
Assistant Attorney General  
1302 E. Hwy. 14 Suite 1  
Pierre, SD 57501  
605-773-3215  
Email: Chelsea.Wenzel@state.sd.us

Subscribed and sworn to before me this 6th day of September 2024.

  
Notary Public – South Dakota  
(SEAL)

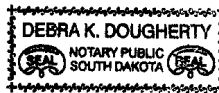

My Commission Expires: September 12, 2029

ed to): Title  
le V, Part B  
ing

ct (i.e. Sup  
Tribe Busine  
will be prop

Ar

Inc

ons, and pro  
Committee o

It is the intent of the Andes Central Schons will be pl  
all programs, services and activities of ne in the Ar  
of the hearing

The Andes Central School District will cr  
development of Indian Policies and Proc and any other  
procedures will be reviewed annually and services a  
are not being adequately met. available for  
ie available

The following policies and accompanying

**POLICY (1):** The Andes Central School  
plans, and information related to educat  
Yankton Sioux Tribe Business and Clair  
and make recommendations. [34CFR22

**PROCEDURES:**

The Andes Central School Distri  
programs (including, but not limit  
Title IV, Part A; Title IV, Part B; Tit  
and Johnson O'Malley program

Representatives from the Distri  
meetings with the Yankton Sioux  
Any suggestions that are given v  
hearing.

Completed applications, evaluati  
as well as the Indian Education C  
January and June.

A summary of proposed applicatio  
second Monday in January and Ju  
advertised one week in advance  
revisions w

The Indian Education Committee  
or modify educational programs a  
in the district. This information is  
identifiable information will be m

Andes Cent  
an Polici  
Imp

District tha  
ered within t

result with lo  
dures (IPPs

procedures

District will  
ional progr

ns Commit

2.94(a)(1))

ct will disse

Minutes from the Indian Education meetings will be posted on the District's website for all parents and officials to review. In addition, participation information will be shared on the District's website for ongoing dissemination of information.

**POLICY (2):** The Andes Central School District will provide an opportunity for the Yankton Sioux Business and Claims Committee and parents of Indian children to provide their views on the District's educational programs and activities, including recommendations on the needs of their children and on how the District can ensure that all children realize the benefits of the educational programs and activities. [34CFR222.94(a)(2)]

**PROCEDURES:**

The Indian Education Committee of the Andes Central School District will meet during the first week of each month for the purpose of addressing comments and concerns of parents of Indian children regarding the District's educational programs and activities. The meeting agendas are posted one week before each meeting in the local newspaper and all meetings are open to the public allowing for tribal representatives and parents of Indian children the opportunity to submit comments and recommendations (either orally or in writing) for consideration. All Indian Education Committee members are available to share information with patrons during the monthly meetings. There is no time restriction on when parents can meet with committee members, as this is ongoing.

A school board representative is a non-voting member of the Indian Education Committee. This allows for the discussion of the needs of the students and ideas to be brought forward to both the Indian Education Committee as well as the School Board.

At each of the monthly school board meetings, (held on the second Monday of each month) a portion of the meeting is set aside for communications from the public. This is a time to offer comments and suggestions regarding programming for Indian students. In addition, two public hearings are scheduled (January and July) which are specifically devoted to addressing questions regarding federal programs. Based upon suggestions from the public, methods of communication as well as ways to maximize participation, and times for meeting from the school board as well as parents of Indian children will be seriously considered to ensure maximum participation. Information will be shared at Indian Education Committee meetings and at meetings with the Yankton Sioux Tribe Business and Claims Committee.

Information will be included in student handbooks/enrollment packets regarding opportunities for participation in the District.

The District representatives will schedule meetings with the Yankton Sioux Tribe Business and Claims Committee to discuss ongoing programming goals.

**POLICY (3):** The Andes Central School District will annually assess the extent to which Indian children are participating on an equal basis with non-Indian children in the District's education program and activities. [34CFR222.94(a)(3)]

PROCEDURES:

The Andes Central School District's Superintendent and school staff, in conjunction with the Indian Education Committee, will review annual participation data and comments gathered from families, students, and staff throughout the year. The results of the data and its comments will be compiled and shared with the Indian Education Committee and school board and posted on the district's website. In addition comments and/or suggestions brought forth from these conversations will become part of the Committee's approved minutes. This data will be utilized to develop appropriate supports for various programs.

During the public hearings in January and June, information will be gathered relating to Indian children's participation in the LEA's education programs and activities. Schools will attempt to identify all programs including extra-curricular as well as courses, clubs, activities that are not sanctioned by the state's Activities Association to better meet student needs. This listing is fluid as programs may change within the school from year to year. A listing of total enrollment for an identified activity, as well as Native American student enrollment is summarized. For advanced level courses, success rates are also considered.

The Indian Education Committee reviews the participation information and offers suggestions. This review takes place at their regularly scheduled meetings on an ongoing basis as data is collected. It is placed on the IEC agenda, and published in the newspaper for patrons and Tribal officials to respond. This allows for ongoing input from patrons and tribal officials. All suggestions and input will be considered when planning schedules and activities for the upcoming school year.

**POLICY(4):** The Andes Central School District will modify the IPPs if necessary, based upon the results of any assessment or input described in this document. [34CRF222.94(a)(4)]

PROCEDURES:

During the organization meeting of the Indian Education Committee held annually the first week in October, the Indian Policies and Procedures will be reviewed and revised if necessary. Once this had happened, the document will be forwarded to the Andes Central School Board as well as the Yankton Sioux Tribe Business and Claims Committee for review. If necessary, the Indian Education Committee, may suggest revisions at other times of the year as appropriate.

The Indian Education Committee is the primary entity which evaluates suggestions and recommendations for changes. Once draft revisions have been recommended by the Indian Education Committee, the Yankton Sioux Tribe Business and Claims Committee is given a written copy for review. It becomes the Superintendent's responsibility to offer suggestions to the school board regarding changes in the approved Indian Policy and Procedure document. If acceptable, the school board approves the recommendations. The official minutes of the school board make note of the approval by the school board. These minutes are published in the paper as well being available on the District's website.

A written copy of the approved Indian Policies and Procedures document is provided annually to all parents when they enroll their children in the District. The approved IPP is also available on the District's website.

POLICY (5): The Andes Central School District will at least annually respond in writing to comments and recommendations made by the Yankton Sioux Tribe Business and Claims Committee or parents of Indian children, and disseminate the responses to all parties prior to the submission of the IPPs by the District. [34CRF222.94(a)(S)]

PROCEDURES:

The Indian Education Committee, the Superintendent, and building level staff will review parent and student input prior to the preparation of program applications. A summary of the results of the surveys along with how the District proposes to address areas of concern will be distributed to all patrons during fall Parent/Teacher conferences.

Any concerns that are brought forth through the Indian Education Committee or via conversations with the Yankton Sioux Tribe Business and Claims Committee will be responded to in an expedient manner. A summary of recommendations/suggestions will be kept on file in the Superintendent's Office for review and examination.

POLICY (6): The Andes Central School District will annually provide a copy of the IPP to the Yankton Sioux Tribe Business and Claims Committee. [34CRF 222.94(a)(6)]

PROCEDURES:

The Andes Central School District will annually provide a copy of the Indian Policy and Procedures to the Yankton Sioux Tribe Business and Claims Committee for review. This will occur during face to face meetings scheduled. Review of the information and any suggestions they have will be submitted to the Indian Education Committee for consideration at their reorganization meeting held the first week in October.

Signatures represent approval by the designated councils/boards of the attached Indian Policies and Procedures:

  
\_\_\_\_\_  
Ashley Mousseau, Indian Education Committee Chair

12-5-23  
\_\_\_\_\_  
Date

  
\_\_\_\_\_  
Brad Peters, Andes Central Superintendent

12-11-23  
\_\_\_\_\_  
Date

#### ATTESTATIONS

The Andes Central School District attests that it has established the attached Indian Policies and Procedures (IPPs) as required in section 7003 of the Impact Aid law for any children claimed who reside on eligible Indian lands. The IPPs have been adequately disseminated to the tribes and parents of children residing on eligible Indian lands. A copy of the current policies and procedures was attached to the Impact Aid application.

The Andes Central School District attests that it has provided a copy of written responses to comments, concerns and recommendations received from tribal leaders and parents of Indian children through the Indian policies and procedures consultation process and disseminated these responses to tribal leaders and parents of Indian children prior to the submission of their Impact Aid application.

  
\_\_\_\_\_  
Debra Houseman, Andes Central School Board President

12/12/23  
\_\_\_\_\_  
Date

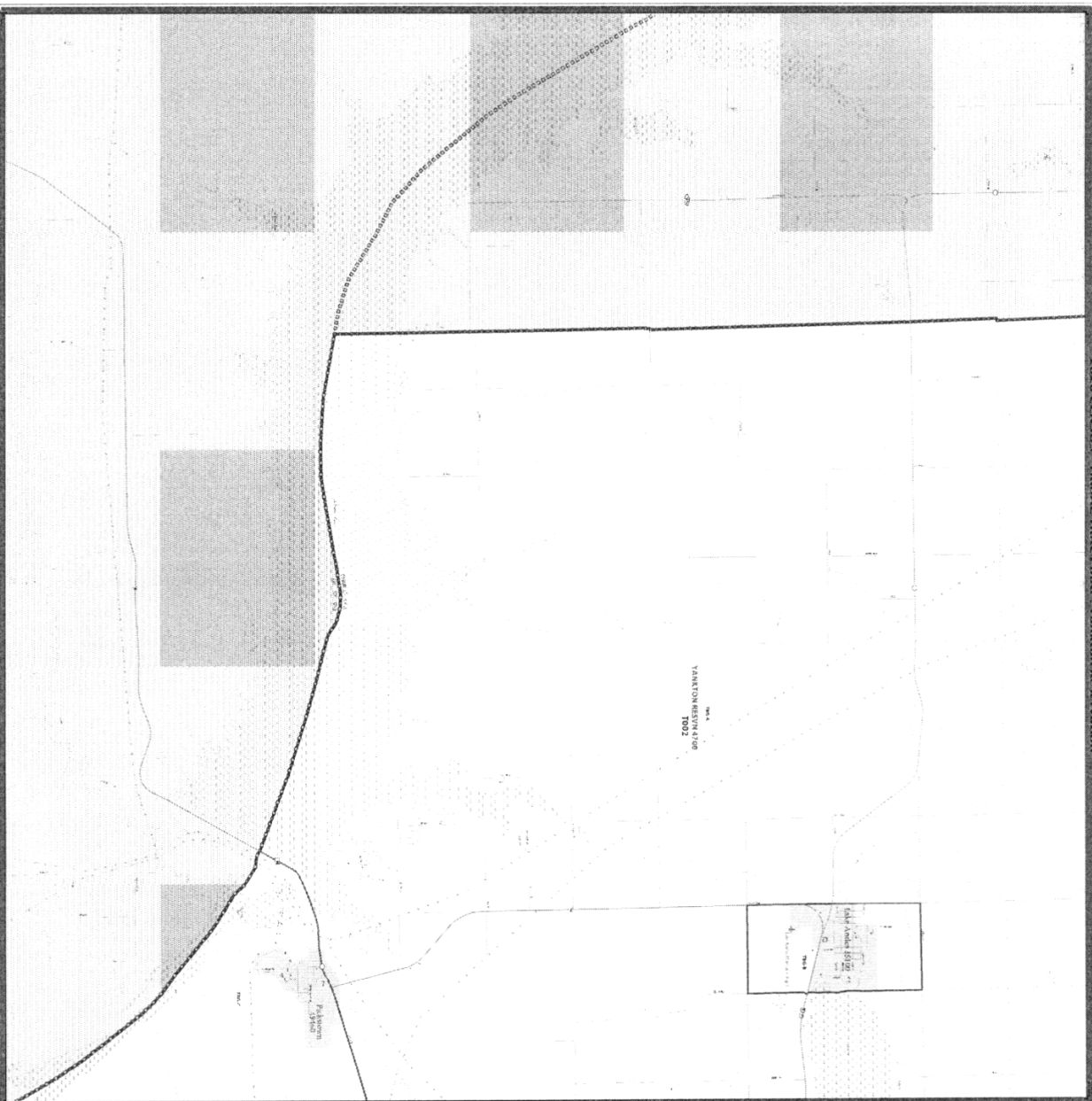

YANKTON RESERVATION  
 1862  
 1863  
 1864  
 1865  
 1866  
 1867  
 1868  
 1869  
 1870  
 1871  
 1872  
 1873  
 1874  
 1875  
 1876  
 1877  
 1878  
 1879  
 1880  
 1881  
 1882  
 1883  
 1884  
 1885  
 1886  
 1887  
 1888  
 1889  
 1890  
 1891  
 1892  
 1893  
 1894  
 1895  
 1896  
 1897  
 1898  
 1899  
 1900

YANKTON RESERVATION  
 1901  
 1902  
 1903  
 1904  
 1905  
 1906  
 1907  
 1908  
 1909  
 1910  
 1911  
 1912  
 1913  
 1914  
 1915  
 1916  
 1917  
 1918  
 1919  
 1920

YANKTON RESERVATION  
 1921  
 1922  
 1923  
 1924  
 1925  
 1926  
 1927  
 1928  
 1929  
 1930  
 1931  
 1932  
 1933  
 1934  
 1935  
 1936  
 1937  
 1938  
 1939  
 1940

YANKTON RESERVATION  
 1941  
 1942  
 1943  
 1944  
 1945  
 1946  
 1947  
 1948  
 1949  
 1950  
 1951  
 1952  
 1953  
 1954  
 1955  
 1956  
 1957  
 1958  
 1959  
 1960

YANKTON RESERVATION  
 1961  
 1962  
 1963  
 1964  
 1965  
 1966  
 1967  
 1968  
 1969  
 1970  
 1971  
 1972  
 1973  
 1974  
 1975  
 1976  
 1977  
 1978  
 1979  
 1980

YANKTON RESERVATION  
 1981  
 1982  
 1983  
 1984  
 1985  
 1986  
 1987  
 1988  
 1989  
 1990  
 1991  
 1992  
 1993  
 1994  
 1995  
 1996  
 1997  
 1998  
 1999  
 2000

YANKTON RESERVATION  
 2001  
 2002  
 2003  
 2004  
 2005  
 2006  
 2007  
 2008  
 2009  
 2010  
 2011  
 2012  
 2013  
 2014  
 2015  
 2016  
 2017  
 2018  
 2019  
 2020

YANKTON RESERVATION  
 2021  
 2022  
 2023  
 2024  
 2025  
 2026  
 2027  
 2028  
 2029  
 2030  
 2031  
 2032  
 2033  
 2034  
 2035  
 2036  
 2037  
 2038  
 2039  
 2040

YANKTON RESERVATION  
 2041  
 2042  
 2043  
 2044  
 2045  
 2046  
 2047  
 2048  
 2049  
 2050  
 2051  
 2052  
 2053  
 2054  
 2055  
 2056  
 2057  
 2058  
 2059  
 2060

YANKTON RESERVATION  
 2061  
 2062  
 2063  
 2064  
 2065  
 2066  
 2067  
 2068  
 2069  
 2070  
 2071  
 2072  
 2073  
 2074  
 2075  
 2076  
 2077  
 2078  
 2079  
 2080

YANKTON RESERVATION  
 2081  
 2082  
 2083  
 2084  
 2085  
 2086  
 2087  
 2088  
 2089  
 2090  
 2091  
 2092  
 2093  
 2094  
 2095  
 2096  
 2097  
 2098  
 2099  
 2100

YANKTON RESERVATION  
 2101  
 2102  
 2103  
 2104  
 2105  
 2106  
 2107  
 2108  
 2109  
 2110  
 2111  
 2112  
 2113  
 2114  
 2115  
 2116  
 2117  
 2118  
 2119  
 2120

YANKTON RESERVATION  
 2121  
 2122  
 2123  
 2124  
 2125  
 2126  
 2127  
 2128  
 2129  
 2130  
 2131  
 2132  
 2133  
 2134  
 2135  
 2136  
 2137  
 2138  
 2139  
 2140

YANKTON RESERVATION  
 2141  
 2142  
 2143  
 2144  
 2145  
 2146  
 2147  
 2148  
 2149  
 2150  
 2151  
 2152  
 2153  
 2154  
 2155  
 2156  
 2157  
 2158  
 2159  
 2160

YANKTON RESERVATION  
 2161  
 2162  
 2163  
 2164  
 2165  
 2166  
 2167  
 2168  
 2169  
 2170  
 2171  
 2172  
 2173  
 2174  
 2175  
 2176  
 2177  
 2178  
 2179  
 2180

YANKTON RESERVATION  
 2181  
 2182  
 2183  
 2184  
 2185  
 2186  
 2187  
 2188  
 2189  
 2190  
 2191  
 2192  
 2193  
 2194  
 2195  
 2196  
 2197  
 2198  
 2199  
 2200

YANKTON RESERVATION  
 2201  
 2202  
 2203  
 2204  
 2205  
 2206  
 2207  
 2208  
 2209  
 2210  
 2211  
 2212  
 2213  
 2214  
 2215  
 2216  
 2217  
 2218  
 2219  
 2220

YANKTON RESERVATION  
 2221  
 2222  
 2223  
 2224  
 2225  
 2226  
 2227  
 2228  
 2229  
 2230  
 2231  
 2232  
 2233  
 2234  
 2235  
 2236  
 2237  
 2238  
 2239  
 2240

YANKTON RESERVATION  
 2241  
 2242  
 2243  
 2244  
 2245  
 2246  
 2247  
 2248  
 2249  
 2250  
 2251  
 2252  
 2253  
 2254  
 2255  
 2256  
 2257  
 2258  
 2259  
 2260

YANKTON RESERVATION  
 2261  
 2262  
 2263  
 2264  
 2265  
 2266  
 2267  
 2268  
 2269  
 2270  
 2271  
 2272  
 2273  
 2274  
 2275  
 2276  
 2277  
 2278  
 2279  
 2280

YANKTON RESERVATION  
 2281  
 2282  
 2283  
 2284  
 2285  
 2286  
 2287  
 2288  
 2289  
 2290  
 2291  
 2292  
 2293  
 2294  
 2295  
 2296  
 2297  
 2298  
 2299  
 2300

YANKTON RESERVATION  
 2301  
 2302  
 2303  
 2304  
 2305  
 2306  
 2307  
 2308  
 2309  
 2310  
 2311  
 2312  
 2313  
 2314  
 2315  
 2316  
 2317  
 2318  
 2319  
 2320

YANKTON RESERVATION  
 2321  
 2322  
 2323  
 2324  
 2325  
 2326  
 2327  
 2328  
 2329  
 2330  
 2331  
 2332  
 2333  
 2334  
 2335  
 2336  
 2337  
 2338  
 2339  
 2340

YANKTON RESERVATION  
 2341  
 2342  
 2343  
 2344  
 2345  
 2346  
 2347  
 2348  
 2349  
 2350  
 2351  
 2352  
 2353  
 2354  
 2355  
 2356  
 2357  
 2358  
 2359  
 2360

YANKTON RESERVATION  
 2361  
 2362  
 2363  
 2364  
 2365  
 2366  
 2367  
 2368  
 2369  
 2370  
 2371  
 2372  
 2373  
 2374  
 2375  
 2376  
 2377  
 2378  
 2379  
 2380

YANKTON RESERVATION  
 2381  
 2382  
 2383  
 2384  
 2385  
 2386  
 2387  
 2388  
 2389  
 2390  
 2391  
 2392  
 2393  
 2394  
 2395  
 2396  
 2397  
 2398  
 2399  
 2400

YANKTON RESERVATION  
 2401  
 2402  
 2403  
 2404  
 2405  
 2406  
 2407  
 2408  
 2409  
 2410  
 2411  
 2412  
 2413  
 2414  
 2415  
 2416  
 2417  
 2418  
 2419  
 2420

YANKTON RESERVATION  
 2421  
 2422  
 2423  
 2424  
 2425  
 2426  
 2427  
 2428  
 2429  
 2430  
 2431  
 2432  
 2433  
 2434  
 2435  
 2436  
 2437  
 2438  
 2439  
 2440

YANKTON RESERVATION  
 2441  
 2442  
 2443  
 2444  
 2445  
 2446  
 2447  
 2448  
 2449  
 2450  
 2451  
 2452  
 2453  
 2454  
 2455  
 2456  
 2457  
 2458  
 2459  
 2460

YANKTON RESERVATION  
 2461  
 2462  
 2463  
 2464  
 2465  
 2466  
 2467  
 2468  
 2469  
 2470  
 2471  
 2472  
 2473  
 2474  
 2475  
 2476  
 2477  
 2478  
 2479  
 2480

YANKTON RESERVATION  
 2481  
 2482  
 2483  
 2484  
 2485  
 2486  
 2487  
 2488  
 2489  
 2490  
 2491  
 2492  
 2493  
 2494  
 2495  
 2496  
 2497  
 2498  
 2499  
 2500

YANKTON RESERVATION  
 2501  
 2502  
 2503  
 2504  
 2505  
 2506  
 2507  
 2508  
 2509  
 2510  
 2511  
 2512  
 2513  
 2514  
 2515  
 2516  
 2517  
 2518  
 2519  
 2520

YANKTON RESERVATION  
 2521  
 2522  
 2523  
 2524  
 2525  
 2526  
 2527  
 2528  
 2529  
 2530  
 2531  
 2532  
 2533  
 2534  
 2535  
 2536  
 2537  
 2538  
 2539  
 2540

YANKTON RESERVATION  
 2541  
 2542  
 2543  
 2544  
 2545  
 2546  
 2547  
 2548  
 2549  
 2550  
 2551  
 2552  
 2553  
 2554  
 2555  
 2556  
 2557  
 2558  
 2559  
 2560

YANKTON RESERVATION  
 2561  
 2562  
 2563  
 2564  
 2565  
 2566  
 2567  
 2568  
 2569  
 2570  
 2571  
 2572  
 2573  
 2574  
 2575  
 2576  
 2577  
 2578  
 2579  
 2580

YANKTON RESERVATION  
 2581  
 2582  
 2583  
 2584  
 2585  
 2586  
 2587  
 2588  
 2589  
 2590  
 2591  
 2592  
 2593  
 2594  
 2595  
 2596  
 2597  
 2598  
 2599  
 2600

YANKTON RESERVATION  
 2601  
 2602  
 2603  
 2604  
 2605  
 2606  
 2607  
 2608  
 2609  
 2610  
 2611  
 2612  
 2613  
 2614  
 2615  
 2616  
 2617  
 2618  
 2619  
 2620

YANKTON RESERVATION  
 2621  
 2622  
 2623  
 2624  
 2625  
 2626  
 2627  
 2628  
 2629  
 2630  
 2631  
 2632  
 2633  
 2634  
 2635  
 2636  
 2637  
 2638  
 2639  
 2640

YANKTON RESERVATION  
 2641  
 2642  
 2643  
 2644  
 2645  
 2646  
 2647  
 2648  
 2649  
 2650  
 2651  
 2652  
 2653  
 2654  
 2655  
 2656  
 2657  
 2658  
 2659  
 2660

YANKTON RESERVATION  
 2661  
 2662  
 2663  
 2664  
 2665  
 2666  
 2667  
 2668  
 2669  
 2670  
 2671  
 2672  
 2673  
 2674  
 2675  
 2676  
 2677  
 2678  
 2679  
 2680

YANKTON RESERVATION  
 2681  
 2682  
 2683  
 2684  
 2685  
 2686  
 2687  
 2688  
 2689  
 2690  
 2691  
 2692  
 2693  
 2694  
 2695  
 2696  
 2697  
 2698  
 2699  
 2700

YANKTON RESERVATION  
 2701  
 2702  
 2703  
 2704  
 2705  
 2706  
 2707  
 2708  
 2709  
 2710  
 2711  
 2712  
 2713  
 2714  
 2715  
 2716  
 2717  
 2718  
 2719  
 2720

YANKTON RESERVATION  
 2721  
 2722  
 2723  
 2724  
 2725  
 2726  
 2727  
 2728  
 2729  
 2730  
 2731  
 2732  
 2733  
 2734  
 2735  
 2736  
 2737  
 2738  
 2739  
 2740

YANKTON RESERVATION  
 2741  
 2742  
 2743  
 2744  
 2745  
 2746  
 2747  
 2748  
 2749  
 2750  
 2751  
 2752  
 2753  
 2754  
 2755  
 2756  
 2757  
 2758  
 2759  
 2760

YANKTON RESERVATION  
 2761  
 2762  
 2763  
 2764  
 2765  
 2766  
 2767  
 2768  
 2769  
 2770  
 2771  
 2772  
 2773  
 2774  
 2775  
 2776  
 2777  
 2778  
 2779  
 2780

YANKTON RESERVATION  
 2781  
 2782  
 2783  
 2784  
 2785  
 2786  
 2787  
 2788  
 2789  
 2790  
 2791  
 2792  
 2793  
 2794  
 2795  
 2796  
 2797  
 2798  
 2799  
 2800

YANKTON RESERVATION  
 2801  
 2802  
 2803  
 2804  
 2805  
 2806  
 2807  
 2808  
 2809  
 2810  
 2811  
 2812  
 2813  
 2814  
 2815  
 2816  
 2817  
 2818  
 2819  
 2820

YANKTON RESERVATION  
 2821  
 2822  
 2823  
 2824  
 2825  
 2826  
 2827  
 2828  
 2829  
 2830  
 2831  
 2832  
 2833  
 2834  
 2835  
 2836  
 2837  
 2838  
 2839  
 2840

YANKTON RESERVATION  
 2841  
 2842  
 2843  
 2844  
 2845  
 2846  
 2847  
 2848  
 2849  
 2850  
 2851  
 2852  
 2853  
 2854  
 2855  
 2856  
 2857  
 2858  
 2859  
 2860

YANKTON RESERVATION  
 2861  
 2862  
 2863  
 2864  
 2865  
 2866  
 2867  
 2868  
 2869  
 2870  
 2871  
 2872  
 2873  
 2874  
 2875  
 2876  
 2877  
 2878  
 2879  
 2880

YANKTON RESERVATION  
 2881  
 2882  
 2883  
 2884  
 2885  
 2886  
 2887  
 2888  
 2889  
 2890  
 2891  
 2892  
 2893  
 2894  
 2895  
 2896  
 2897  
 2898  
 2899  
 2900

YANKTON RESERVATION  
 2901  
 2902  
 2903  
 2904  
 2905  
 2906  
 2907  
 2908  
 2909  
 2910  
 2911  
 2912  
 2913  
 2914  
 2915  
 2916  
 2917  
 2918  
 2919  
 2920

YANKTON RESERVATION  
 2921  
 2922  
 2923  
 2924  
 2925  
 2926  
 2927  
 2928  
 2929  
 2930  
 2931  
 2932  
 2933  
 2934  
 2935  
 2936  
 2937  
 2938  
 2939  
 2940

YANKTON RESERVATION  
 2941  
 2942  
 2943  
 2944  
 2945  
 2946  
 2947  
 2948  
 2949  
 2950  
 2951  
 2952  
 2953  
 2954  
 2955  
 2956  
 2957  
 2958  
 2959  
 2960



## 2020 Census Participant Statistical Areas Program (PSAP) Quick Reference: Tribal Block Groups

A tribal block group<sup>1</sup> is a statistical geographic subdivision of a tribal census tract. Tribal block groups are defined by the Census Bureau in cooperation with tribal officials to provide meaningful, relevant, and reliable data for small geographic areas within the boundaries of federally recognized American Indian reservations (AIRs) and/or off-reservation trust lands (ORTLs) without the imposition of state or county boundaries. The Census Bureau uses tribal block groups in the tabulation and presentation of data from the decennial census and the American Community Survey (ACS).

Census Bureau criteria specify that tribal block groups must:

- Nest within tribal census tract boundaries and by default, nest within the American Indian reservation (AIR) and off-reservation trust land (ORTL) boundaries.
- Cover the entire AIR and/or ORTL. However, defining tribal census tracts and tribal block groups is optional.
- Comprise a reasonably compact and contiguous land area. A non-contiguous tribal block group is permitted if there are physically separate areas that would not meet population or housing unit requirements on their own, in which case the non-contiguous area must be combined with other nearby land area to form the tribal block group.
- Meet the population and/or housing unit thresholds as specified in Table 1. A tribal block group that exceeds thresholds, either above or below, may remain unchanged with justifications. For federally recognized American Indian tribes with AIRs and ORTLs that have fewer than 1,200 residents, the Census Bureau will define one tribal census tract and one tribal block group that encompasses the entirety of the AIR or ORTL.
- Use the letter range A through K (except "I," which could be confused with a number "1") to identify and code the tribal block groups within a tribal census tract. Census blocks will be numbered uniquely within county-based block groups, and thus there will not be a direct relationship between a tribal block group and the census block number.

Census Bureau guidelines recommend that tribal block groups:

- Have boundaries that follow visible features (e.g., roads, rivers) or other acceptable features (e.g., tribal subdivision, incorporated place, and minor civil division boundaries).

<sup>1</sup> Tribal block group was delineated under Tribal Statistical Areas Program (TSAP) in 2010.

**Table 1: Block Group Thresholds**

Block Group Type	Population Threshold	Housing Unit Threshold	Area Measurement Threshold
<b>Tribal Block Groups</b>	Min.: 600	Min.: 240	None
	Max.: 3,000	Max.: 1,200	None

***Refer to the Respondent Guide for complete instructions.***